

NOTE: BREAK ALL CORNERS WITH 0.015" (.38 MM) RADIUS UNLESS OTHERWISE NOTED. STANDARD TOLERANCES TO APPLY UNLESS OTHERWISE SPECIFIED.

CUSTOMER CAN ART STD.	DIE No. EH13415	REV. No. 2
DESCRIPTION 4.000 x 1.000 x 0.125 RECT. TUBE	CUSTOMER PART No.	QUOTE No. 09-0553-1-R-1
		PROPOSAL No. H-14372

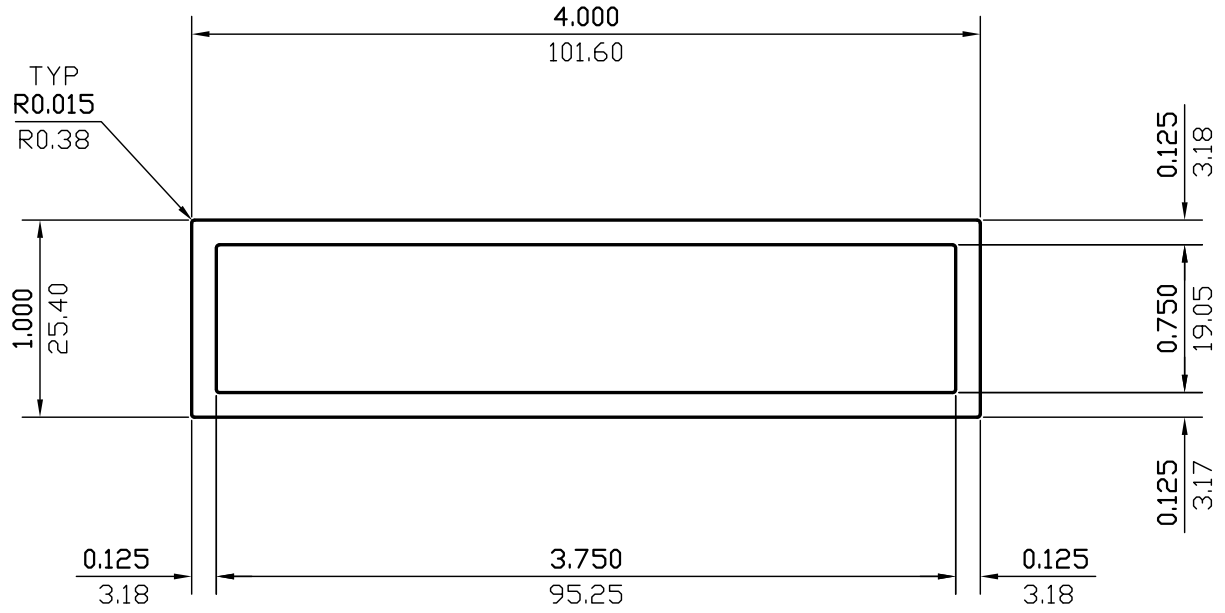

WALL THICKNESS **0.125 (3.18)** EXCEPT AS SHOWN

DATE	REV	DESCRIPTION	BY
03/14/23	2	REMOVED ALLOY	JASON
04/30/09	1	CHANGED CUST. NAME.	PAUL
EST.AREA	1.187	IN. ²	EST.AREA 766.134 MM. ²
EST.WT.	1.401	LBS/FT.	EST.WT. 2.085 KG/M.
EST.PER.	18.948	IN.	EST.PER. 481.292 MM.
OUT PER.	9.974	IN.	OUT PER. 253.3 MM.
C.C.D.	4.116	IN.	C.C.D. 104.545 MM.
FINISH	M/F		ALLOY
CKD BY	FACTOR 14	SCALE 1:1	DWN BY P.M. DATE 06/15/2004

CAN ART

85 PARKSHORE DRIVE
BRAMPTON, ONT L6T 5M1
TEL. NO. (905) 791-1464
FAX NO. (905) 791-9151
WEB: www.canart.com

ALUMINUM EXTRUSION INC.

THIS DRAWING IS NOT NECESSARILY A COPY OF YOUR ORIGINAL. PLEASE APPROVE DIMENSIONS AND TOLERANCES INDICATED. CAN ART ASSUMES NO RESPONSIBILITY EITHER TECHNICAL OR LEGAL FOR HAVING THIS SHAPE MADE. THE CUSTOMER AGREES TO FULLY PROTECT CAN ART ALUMINUM FROM CLAIMS OF OTHERS RESULTING FROM THIS SHAPE.

SIGNED: _____ DATE: _____